

## Safety lever handle 19mm dia on square rose

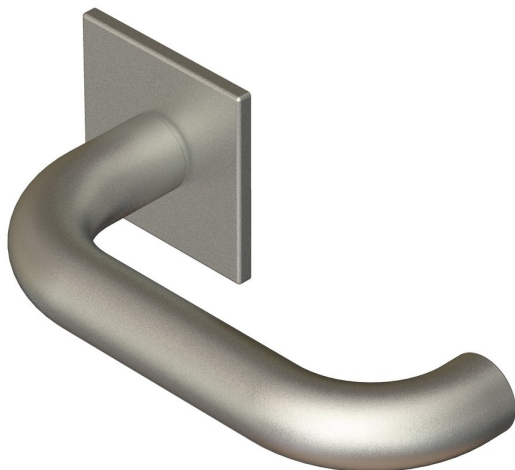

Product image

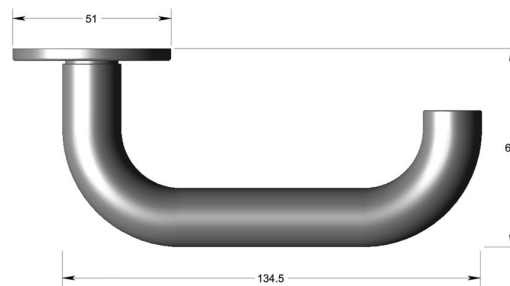

Dimensions drawing (DIM)

**Reference**

FL104 19 SR4 SSS

**Finish**

Incasa satin stainless steel

**Material**

Stainless steel 316

**Backplate**

SR4

**Description**

19mm dia solid round section handle  
Concealed fixing  
High performance bearing rose  
Back to back fixings  
Conforms to EN1906 high usage  
Suitable for use on fire doors