

Concealed bearing Falling butt hinge right hand

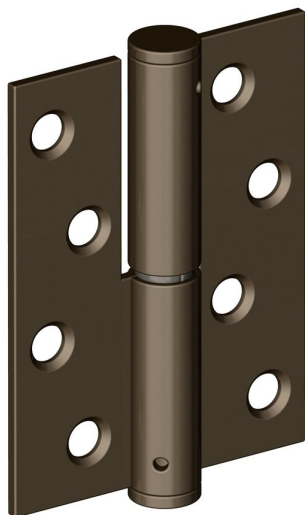

Product image

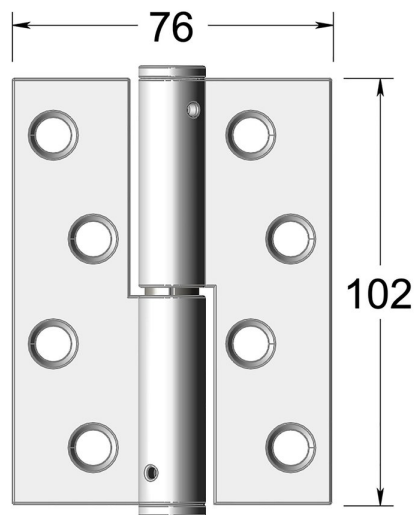

Dimensions drawing (DIM)

Reference

FH053 S DBZ

Finish

Incasa dark bronze

Corners

Square

Material

Stainless steel 316

Size

102x76mm

Description

Suitable for doors up to 80kgs

High performance low friction / low wear concealed bearing

Tested to EN1935 grade 11

Available with 8 & 12mm rise over 180 degrees