

Reduced ligature hinge

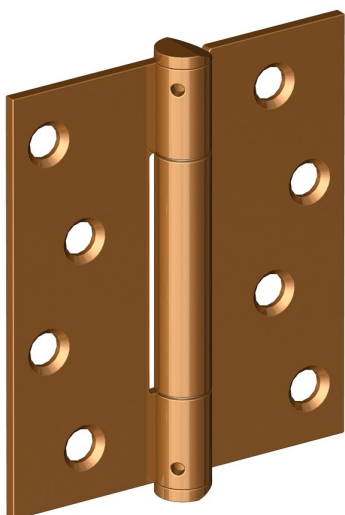

Product image

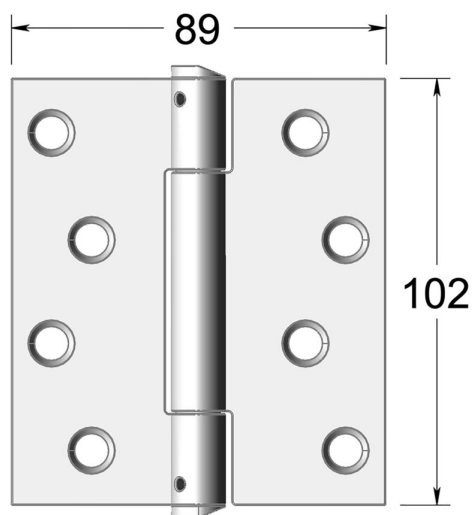

Dimensions drawing (DIM)

Reference

FH031 89 S PCU

Finish

Trad polished copper

Corners

Square

Material

Stainless steel 316

Size

102x89mm

Description

Suitable for doors up to 160kgs
 High performance low friction / low wear concealed bearing
 Anti-ligature knuckles
 Tested to EN1935 grade 14
 For use on timber fire doors up to FD60
 Certifire approved
 UKCA marked