

## Reduced ligature hinge

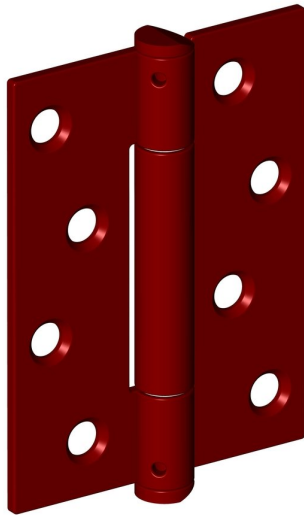

Product image

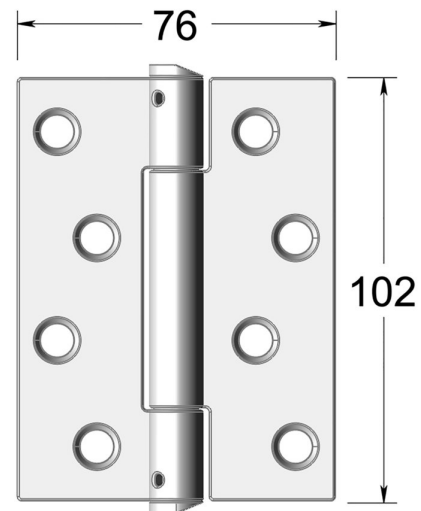

Dimensions drawing (DIM)

**Reference**

FH031 76 S RAL

**Finish**

RAL

**Corners**

Square

**Material**

Stainless steel 316

**Size**

102x76mm

**Description**

Suitable for doors up to 160kgs  
High performance low friction / low wear concealed bearing  
Anti-ligature knuckles  
Tested to EN1935 grade 14  
For use on timber fire doors up to FD60  
Certifire approved  
UKCA marked