

Concealed bearing Lift off hinge right hand

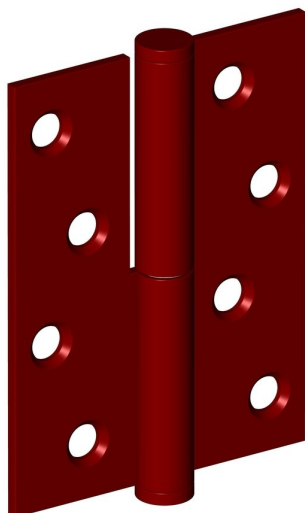

Product image

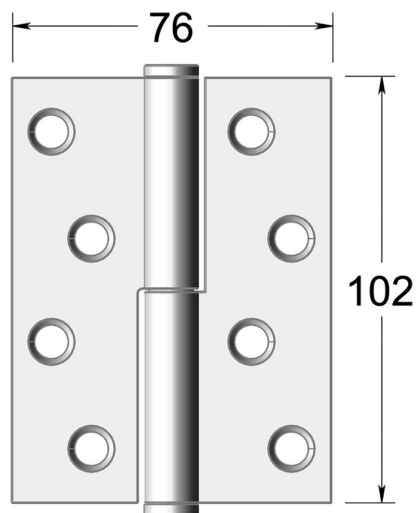

Dimensions drawing (DIM)

Reference

FH021RH 76 S RAL

Finish

RAL

Corners

Square

Material

Stainless steel 316

Size

102x76mm

Description

Suitable for doors up to 120kgs
friction / low wear concealed bearing
For use on timber fire doors up to FD60
Certifire approved
UKCA marked

High performance low
Tested to EN1935 grade 13