

Concealed bearing Lift off hinge right hand

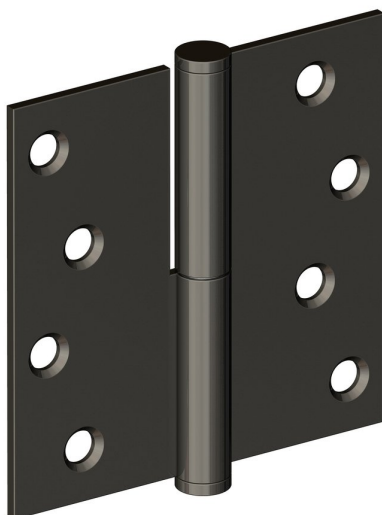

Product image

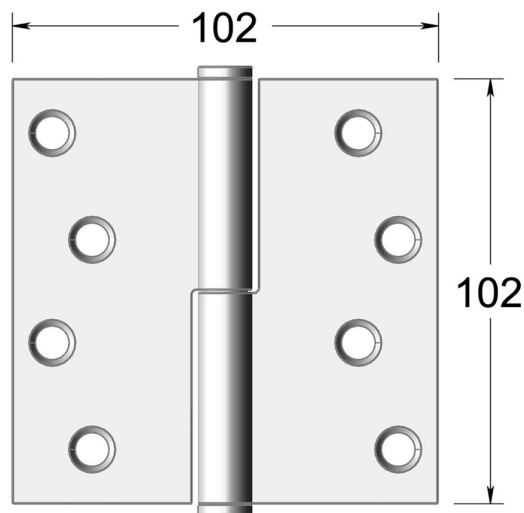

Dimensions drawing (DIM)

Reference

FH021RH 102 S PBKN

Finish

Trad polished black nickel

Corners

Square

Material

Stainless steel 316

Size

102x102mm

Description

Suitable for doors up to 120kgs
friction / low wear concealed bearing
For use on timber fire doors up to FD60
Certifire approved
UKCA marked

High performance low
Tested to EN1935 grade 13