

Concealed bearing Lift off hinge left hand

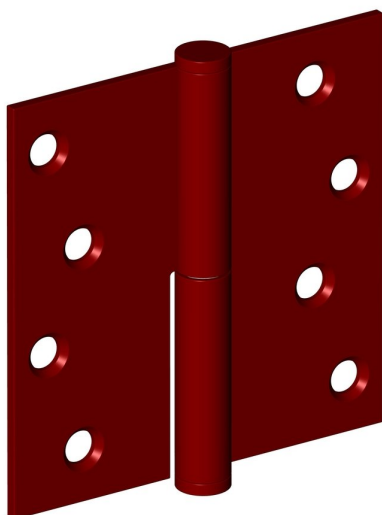

Product image

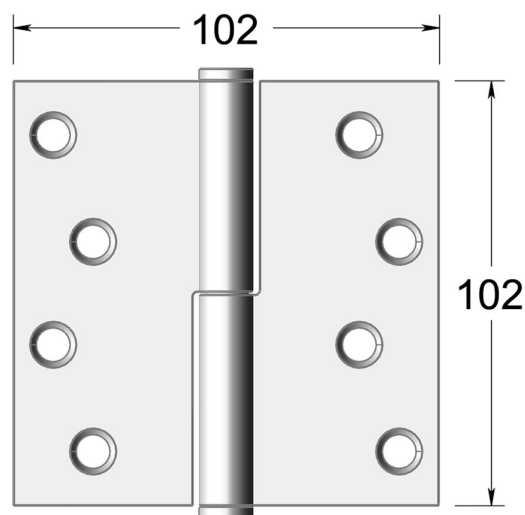

Dimensions drawing (DIM)

Reference

FH021LH 102 S RAL

Finish

RAL

Corners

Square

Material

Stainless steel 316

Size

102x102mm

Description

Suitable for doors up to 120kgs
 concealed bearing Tested to EN1935 grade 13
 For use on timber fire doors up to FD60
 Certifire approved
 UKCA marked

High performance low friction / low wear