

## Concealed bearing Lift off hinge left hand

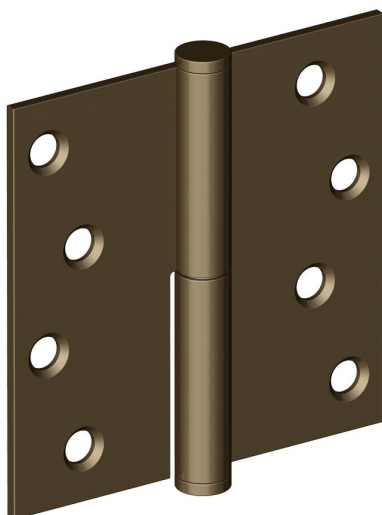

Product image

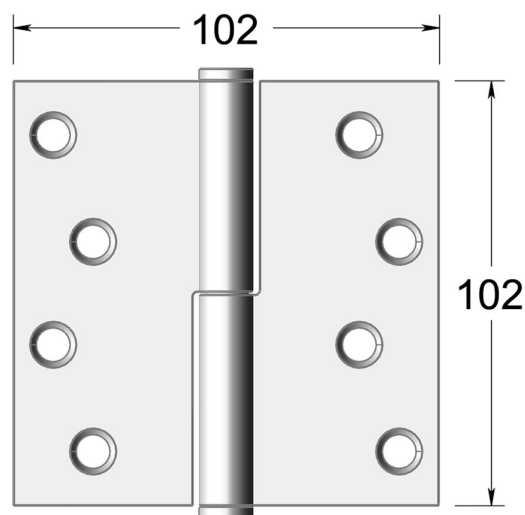

Dimensions drawing (DIM)

**Reference**

FH021LH 102 S MBZ

**Finish**

Incasa medium bronze

**Corners**

Square

**Material**

Stainless steel 316

**Size**

102x102mm

**Description**

Suitable for doors up to 120kgs  
concealed bearing Tested to EN1935 grade 13  
For use on timber fire doors up to FD60  
Certifire approved  
UKCA marked

High performance low friction / low wear