

High performance concealed bearing COVER-PLATE hinge

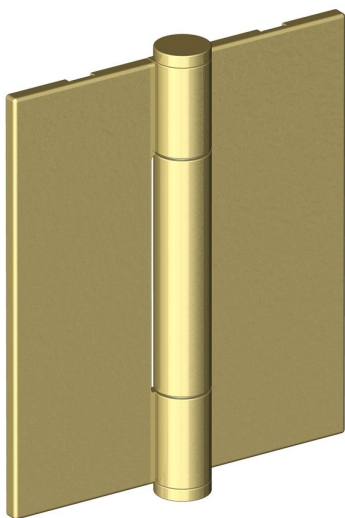

Product image

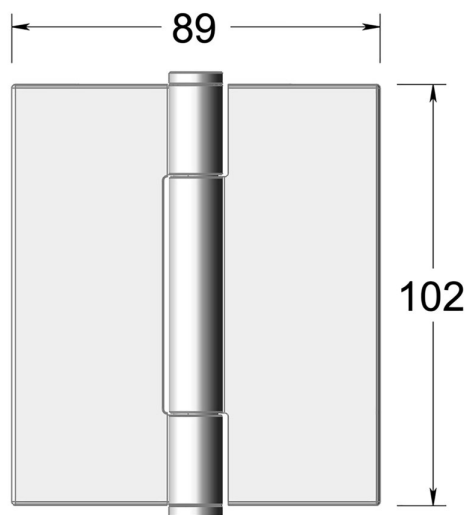

Dimensions drawing (DIM)

Reference

FH011 S 89 PB

Finish

Trad polished brass

Corners

Square

Description

Suitable for doors up to 160kgs
High performance low friction / low wear concealed bearing
Tested to EN1935 grade 14
For use on timber fire doors up to FD120
Certifire approved
UKCA marked

Material

Stainless steel 316

Size

102x89mm