

## High performance concealed bearing COVER-PLATE hinge

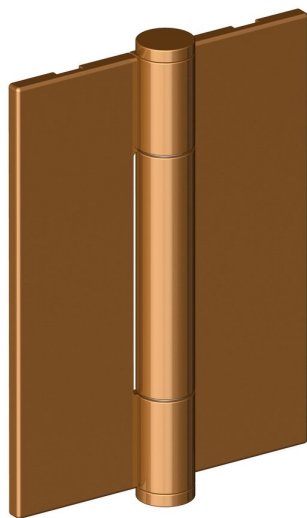

Product image

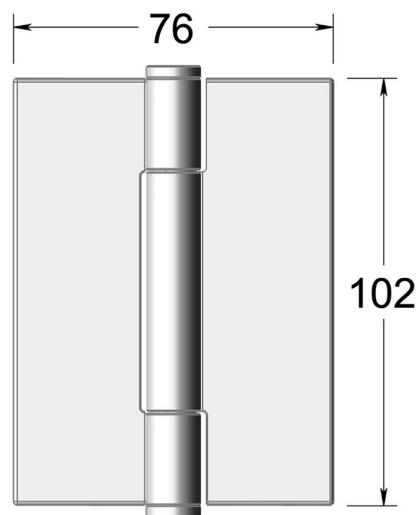

Dimensions drawing (DIM)

**Reference**

FH011 S 76 PCU

**Finish**

Trad polished copper

**Corners**

Square

**Description**

Suitable for doors up to 160kgs  
High performance low friction / low wear concealed bearing  
Tested to EN1935 grade 14  
For use on timber fire doors up to FD120  
Certifire approved  
UKCA marked

**Material**

Stainless steel 316

**Size**

102x76mm