

High performance butterfly butt

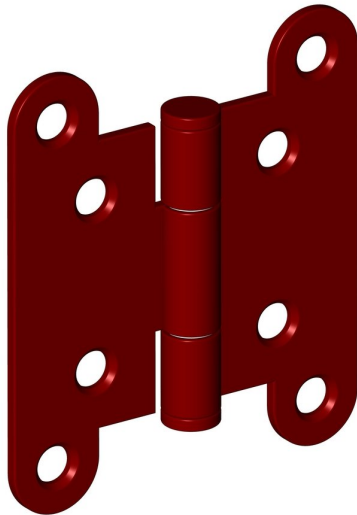

Product image

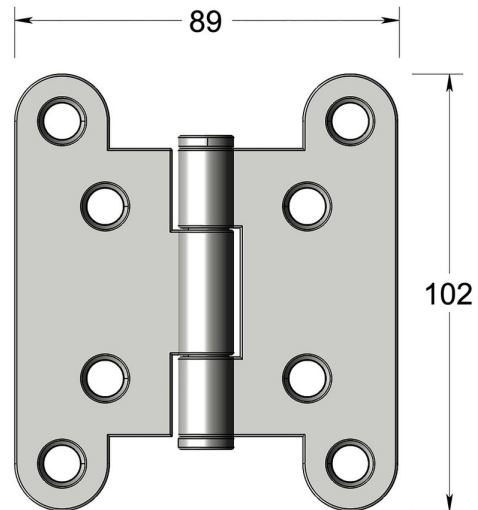

Dimensions drawing (DIM)

Reference

FH061 RAL

Finish

RAL

Corners

Radius

Material

Stainless steel 316

Size

102x89mm

Description

Suitable for doors up to 120kgs
High performance low friction / low wear concealed bearing
Tested to EN1935 grade 13
For use on timber fire doors up to FD120
Certifire approved
UKCA marked