

## High performance concealed bearing butt hinge

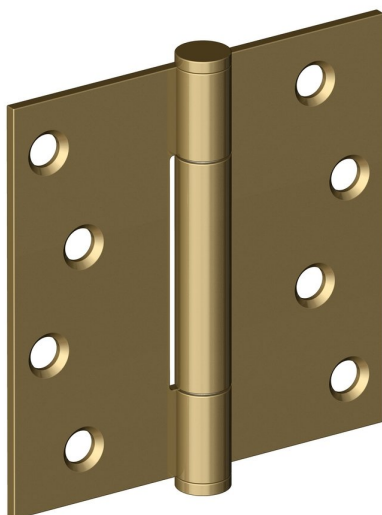

Product image

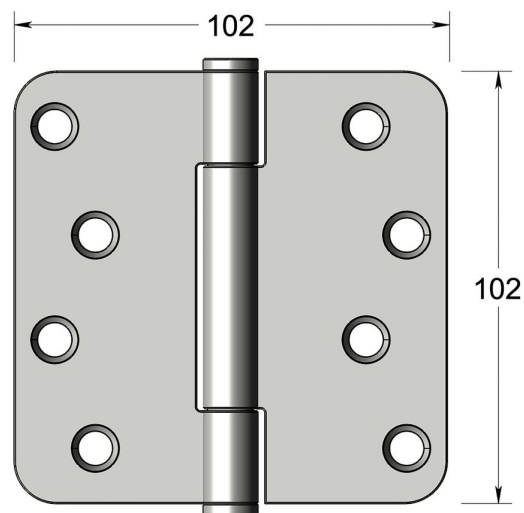

Dimensions drawing (DIM)

**Reference**

FH001 S 100 ABR

**Finish**

Incasa antique brass

**Corners**

Square

**Material**

Stainless steel 316

**Size**

102x102mm

**Description**

Suitable for doors up to 160kgs  
 High performance low friction / low wear concealed bearing  
 Tested to EN1935 grade 14  
 Independently tested to 1,000,000 cycles  
 For use on timber fire doors up to FD120  
 Certifire approved  
 UKCAmarked