

Straight shower rail c/w rings

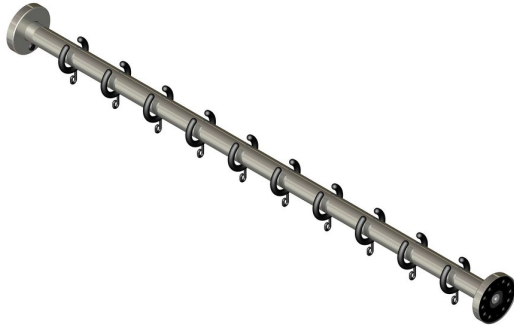

Product image

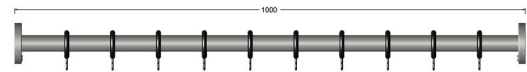

Dimensions drawing (DIM)

Reference

FGR151 1000 PSS

Finish

Incasa polished stainless steel

Material

Stainless steel 316

Length

1000mm

Description

Heavy duty shower rail
 Concealed fixings
 150kg weight capacity
 Conforms to EN 12182
 Fixing packs available for most wall constructions