

Straight Mitred pull handle

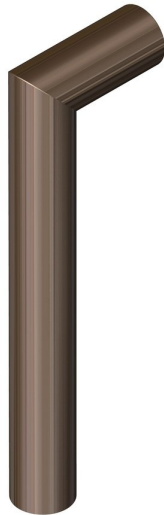

Product image

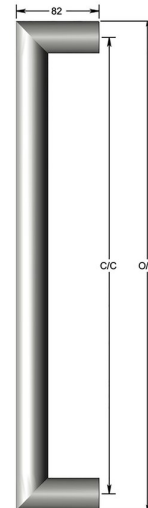

Dimensions drawing (DIM)

Reference

FP008 32 PPVDBZ

Material

Stainless steel 316

Finish

Incasa polished PVD bronze

Diameter

32mm

Description

Thick walled tubular pull handle
Available any length up to 2400mm
May require additional supports depending on length
Fixings available for most door construction