

50mm dia FLAT FRONT BALL knob on 9mm round rose

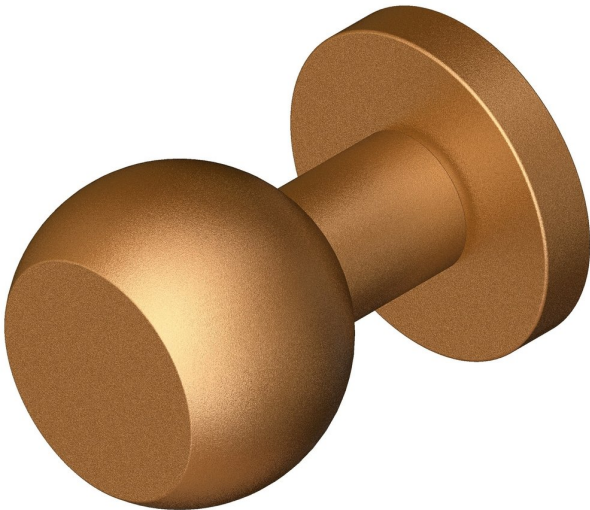

Product image



Dimensions drawing (DIM)

Reference

FKN002 RR9 SPVDCU

Finish

Incasa satin PVD copper

Material

Stainless steel 316

Backplate

RR9

Description

Solid mortice knob
Concealed fixing
High performance bearing rose
Back to back fixings
Conforms to EN1906 high usage
Suitable for use on fire doors