

50mm BALL knob on square rose

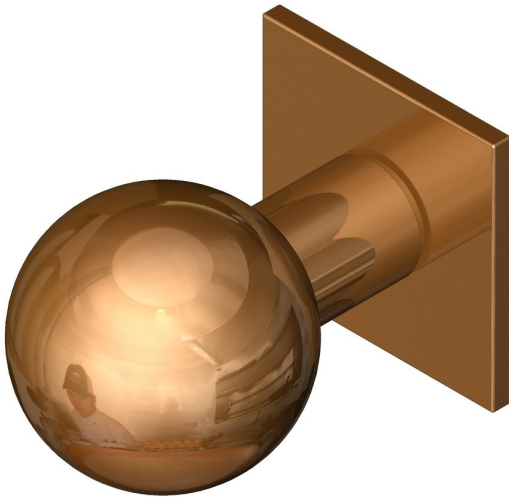

Product image

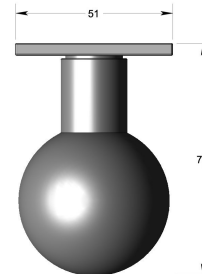

Dimensions drawing (DIM)

Reference

FKN001 SR4 PPVDCU

Finish

Incasa polished PVD copper

Material

Stainless steel 316

Backplate

SR4

Description

Solid mortice knob
Concealed fixing
High performance bearing rose
Back to back fixings
Conforms to EN1906 high usage
Suitable for use on fire doors